

HANDSPANNFUTTER

Schwerspann-Vierbackenfutter mit unabhängig verstellbaren XL-Backen

Heavy duty 4 jaw independent chuck XL

- Schwerspann-Stahlkörper
- Direkte Verschraubung
- (Extra-)Lange Grundbacken für erhöhte Steifigkeit
- Verstellspindeln gehärtet und geschliffen
- Größere Abmessungen auf Anfrage
- Gewichtsangaben Circa-Werte
- Ersatzteile auf Anfrage

- Heavy duty steel body
- Direct mounting
- Long master jaws for increased rigidity
- Operating screws hardened and ground
- Larger dimensions on request
- Approximated weights
- Spare parts on request

Speziell ausgelegt für die Bearbeitung von besonders schweren Werkstücken in Horizontaldrehmaschinen

Specially designed to clamp heavy pieces in horizontal lathes

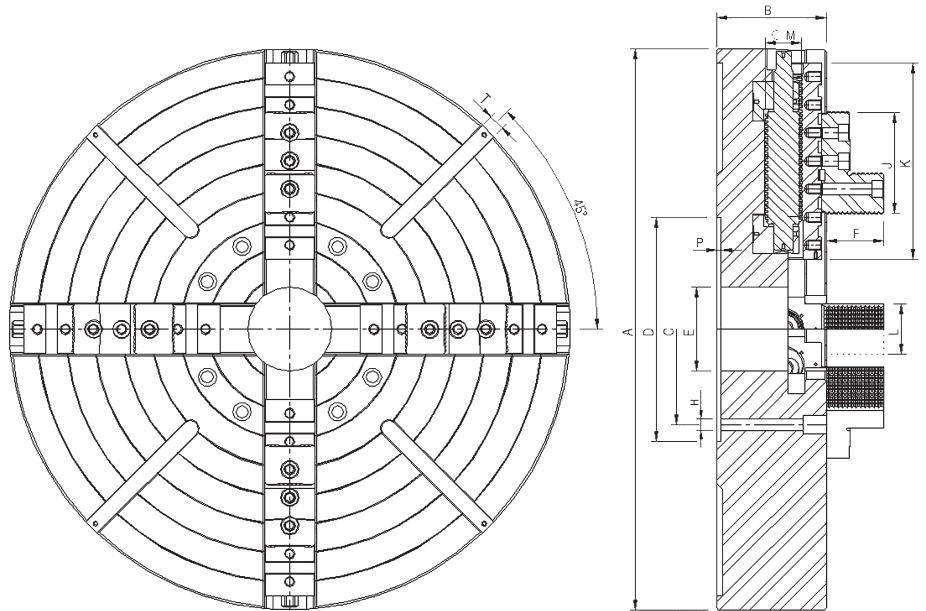

A	A	B	C	D	H	E	F	J	L	K	T-Nut	M
mm	inch	mm	mm	mm	mm	mm	mm	mm	mm	mm	T-slot	mm
600	24	150	235	300	8xM20	120	78	130	75	203	4x22	Ø 50
700	28	150	235	300	8xM20	140	78	130	75	203	4x22	Ø 50
800	32	150	330,2	380	8xM24	155	78	130	75	280	4x22	Ø 50
900	36	150	330,2	380	8xM24	160	78	130	75	315	4x22	Ø 50
1000	40	180	330,2	380	8xM24	170	102	180	90	350	4x22	Ø 64
1200	48	180	463,6	520	8xM24	180	102	180	90	450	4x22	Ø 64
1400	56	185	463,6	520	8xM24	180	102	180	90	550	4x22	Ø 64
1500	60	185	647,6	720	8xM30	180	102	180	90	550	4x22	Ø 64
1600	63	195	647,6	720	8xM30	190	102	180	100	650	8x28	Ø 64
1800	71	205	647,6	720	8xM30	200	102	180	100	650	8x28	Ø 64

A	A	Material	Max. min ⁻¹	Max. Anzugsdrehmoment	Klemmkraft	Gewicht kg	Max. Spann-Ø mm	Min. Spann-Ø mm	Max. Gewicht kg zwischen Spannfutter und Reitstock
mm	inch	Material	Max. R.P.M	Max. Torque on Key	Clamping Force	Weight kg	Max. Clamping Ø mm	Min. Clamping Ø mm	Max. Weight between chuck and tailstock kg
600	24	Stahl / Steel	970	800 Nm	55000 N	260	600	80	10000
700	28	Stahl / Steel	873	800 Nm	55000 N	380	700	100	10000
800	32	Stahl / Steel	764	900 Nm	62500 N	510	800	110	12000
900	36	Stahl / Steel	679	900 Nm	62500 N	625	900	115	12000
1000	40	Stahl / Steel	611	1100 Nm	70000 N	980	1000	125	20000
1200	48	Stahl / Steel	509	1100 Nm	70000 N	1400	1200	135	22000
1400	56	Stahl / Steel	437	1100 Nm	70000 N	1920	1400	135	25000
1500	60	Stahl / Steel	407	1100 Nm	70000 N	2290	1500	135	25000
1600	63	Stahl / Steel	382	1100 Nm	70000 N	2750	1600	145	45000
1800	71	Stahl / Steel	340	1100 Nm	70000 N	3530	1800	150	50000
2000	79	Stahl / Steel	306	1200 Nm	100000 N	5000	2000	200	60000

MANUAL CHUCKS

Schwerspann-Vierbackenfutter mit unabhängig verstellbaren XL-Backen

Heavy duty 4 jaw independent chuck XL

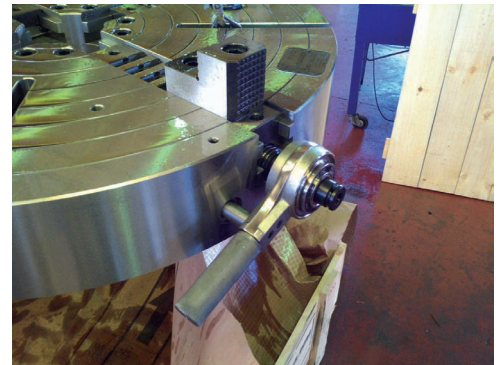
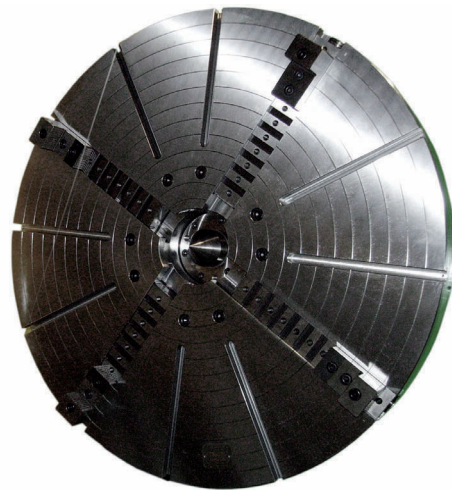

Wir empfehlen Ihnen, einen Kraftvervielfältiger zu verwenden
We recommend to use a multiplier wrench

Ø ABMESSUNGEN SIZE		ZYLINDRISCHE ZENTRIERAUFNAHME RECESS MOUNT		CAMLOCK			DIN 55026			DIN 55027		
mm	inch	GUSS CAST IRON	STAHL STEEL		GUSS CAST IRON	STAHL STEEL		GUSS CAST IRON	STAHL STEEL		GUSS CAST IRON	STAHL STEEL
600	24		1IH4R60000	D-8		1IH4R60045	A-8		1IH4R60015	8		1IH4R60025
				D-11		1IH4R60046	A-11		1IH4R60016	11		1IH4R60026
700	28		1IH4R70000	D-8		1IH4R70045	A-8		1IH4R70015	11		1IH4R70026
				D-11		1IH4R70046	A-11		1IH4R70016	15		1IH4R70027
800	32		1IH4R80000	D-11		1IH4R80046	A-11		1IH4R80016	11		1IH4R80026
				D-15		1IH4R80047	A-15		1IH4R80017	15		1IH4R80027
900	36		1IH4R90000	D-11		1IH4R90046	A-11		1IH4R90016	11		1IH4R90026
				D-15		1IH4R90047	A-15		1IH4R90017	15		1IH4R90027
1000	40		1IH4R01000	D-11		1IH4R01046	A-11		1IH4R01016	11		1IH4R01026
				D-15		1IH4R01047	A-15		1IH4R01017	15		1IH4R01027
				D-20		1IH4R01048	A-20		1IH4R01018	20		1IH4R01028
				D-11		1IH4R01246	A-11		1IH4R01216	11		1IH4R01226
1200	48		1IH4R01200	D-15		1IH4R01247	A-15		1IH4R01217	15		1IH4R01227
				D-20		1IH4R01248	A-20		1IH4R01218	20		1IH4R01228
				D-11		1IH4R01446	A-11		1IH4R01416	11		1IH4R01426
				D-15		1IH4R01447	A-15		1IH4R01417	15		1IH4R01427
1400	55		1IH4R01400	D-20		1IH4R01448	A-20		1IH4R01418	20		1IH4R01428
				D-15		1IH4R01547	A-15		1IH4R01517	15		1IH4R01527
				D-20		1IH4R01548	A-20		1IH4R01518	20		1IH4R01528
				D-15		1IH4R01647	A-15		1IH4R01617	15		1IH4R01627
1600	64		1IH4R01600	D-20		1IH4R01648	A-20		1IH4R01618	20		1IH4R01628
				D-15		1IH4R01847	A-15		1IH4R01817	15		1IH4R01827
				D-20		1IH4R01848	A-20		1IH4R01818	20		1IH4R01828
				D-28		1IH4R01849	A-28		1IH4R01819	28		1IH4R01829
1800	71		1IH4R01800	D-15		1IH4R02047	A-15		1IH4R02017	15		1IH4R02027
				D-20		1IH4R02048	A-20		1IH4R02018	20		1IH4R02028
				D-28		1IH4R02049	A-28		1IH4R02019	28		1IH4R02029
				D-15		1IH4R02047	A-15		1IH4R02017	15		1IH4R02027
2000	79		1IH4R02000	D-20		1IH4R02048	A-20		1IH4R02018	20		1IH4R02028
				D-28		1IH4R02049	A-28		1IH4R02019	28		1IH4R02029
				D-15		1IH4R02047	A-15		1IH4R02017	15		1IH4R02027